

DEFLECTION ANGLE

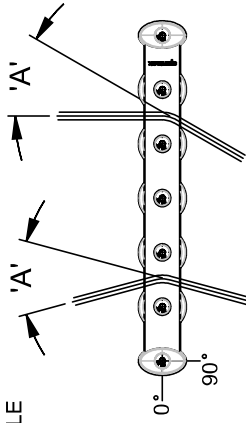

BISECTED ROPE ENTRY

STRAIGHT ROPE ENTRY

DEFLECTION ANGLE, 'A' (°)	MAX ROPE TENSION (KG)
10	3440
15	2300
30	1160
45	780
60	600
90	420

Ø38 COMPOSITE SHEAVE (T38/3)
ALLOY SHEAVE (T38/3A)

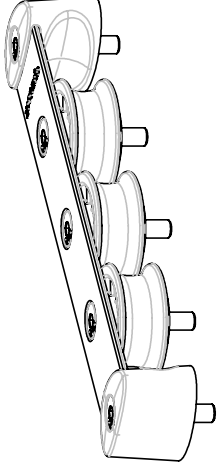
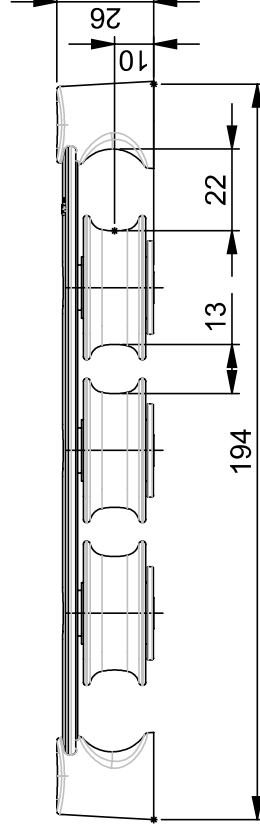
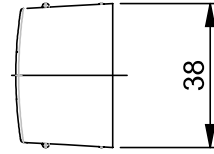
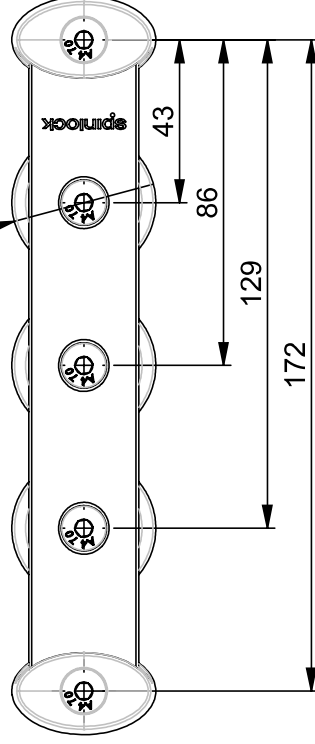

spinlock
BE ADVENTURE-PROOF

WARNING:
IF USING AS DRILL TEMPLATE, ENSURE PRINTER SETTINGS ARE ADJUSTED TO ACCOUNT FOR THE DRAWING SCALE AND ALWAYS CHECK DIMENSIONS BEFORE DRILLING.

COPYRIGHT:
THIS DRAWING IS PROTECTED BY COPYRIGHT. ANY USE IS FORBIDDEN WITHOUT THE WRITTEN CONSENT OF SPINLOCK.

ALL DIMENSIONS IN MM
SCALE 1:2
PAGE SIZE A4
DATE MAR 2018

LINE SIZE: 6-12mm
FASTENERS M6 CSK x 5

PRODUCT CODE T38/3
T38/3A

WEIGHT 154g
212g

MAX LOAD 600kg
600kg

MAX LOAD PER UNIT 900kg
900kg

T38/3

FOR ANY MORE INFO CONTACT
SPT@SPINLOCK.CO.UK